

AFFIDAVIT OF POSTING  
ORDINANCE NO. CB-0-3-83

STATE OF OREGON            )  
                                  )  
COUNTIES OF CLACKAMAS    )  
    AND WASHINGTON         )  
                                  )  
CITY OF WILSONVILLE     )

I, the undersigned, City Recorder of the City of Wilsonville, State of Oregon, being first duly sworn on oath depose and say:

On the 12th day of October, 1983, I caused to be posted copies of the attached Ordinance No. CB-0-3-83, an ordinance authorizing segregation of assessment upon section 13, tax lot 2703, local improvement district no. 3, aka Boeckman Creek Trunk Sewer Line, in the following four public and conspicuous places of the City, to wit:

- WILSONVILLE CITY HALL
- WILSONVILLE POST OFFICE
- LOWRIE'S FOOD MARKET
- KOPPER KITCHEN

The ordinance remained posted for more than five (5) consecutive days prior to the time for said public hearing on the 17th day of October, 1983.

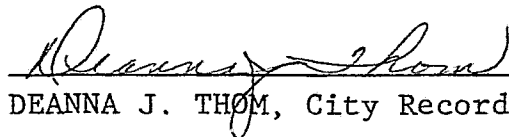
  
\_\_\_\_\_  
DEANNA J. THOM, City Recorder

Subscribed and sworn to before me this 13<sup>th</sup> day of October, 1983.

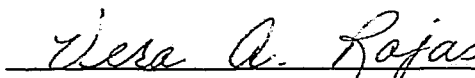
  
\_\_\_\_\_  
NOTARY PUBLIC, STATE OF OREGON

My commission expires: August 23, 1985

ORDINANCE NO. 245

AN ORDINANCE AUTHORIZING SEGREGATION OF ASSESSMENT UPON SECTION 13, TL 2703, LOCAL IMPROVEMENT DISTRICT NO. 3, AKA BOECKMAN CREEK TRUNK SEWER LINE.

WHEREAS, on August 17, 1981, the City Council enacted Ordinance No. 190 levying assessment for a Local Improvement District No. 3, aka Boeckman Creek Trunk Sewer Line; and

WHEREAS, the Boeckman Creek Homeowners Association, representing the individual property owners of the Boeckman Creek Condos, has duly filed with the City Recorder application of division and reapportionment of the assessment levied upon parcels of contiguous land as provided in Section 3.219 in the Wilsonville City Code; and the City Recorder mailed notices to each owner and party having an interest in such property that the City Council would consider such reapportionment at its regular meeting held October 3, 1983, commencing at 7:30 o'clock p.m. at the Wilsonville City Hall, 30000 SW Town Center Loop East; and

WHEREAS, the City Council having heard and considered the matter, including the facts and findings contained in the report of the City Administrator;

NOW, THEREFORE, THE CITY OF WILSONVILLE ORDAINS AS  
FOLLOWS:

1. The segregation for Assessment District No. 3, Section 13, Tax Lot 2703, is hereby segregated for the parcel of property covered under the application on file as described in the report of the City Administrator.
2. The report of the City Administrator is hereby adopted by reference and made a part of this ordinance.
3. The Wilsonville City Council finds that said reapportionment of the assessment lien will not impair the security of the bond holders, or the City of Wilsonville for the collection of the assessment upon said property.
4. It being determined by the Wilsonville City Council an emergency exists, the ordinance shall take effect immediately upon final reading and passage by the Wilsonville City Council.

SUBMITTED to the City Council and read for the first time at a regular meeting thereof on the 3rd day of October, 1983, and scheduled for a second reading at a regular meeting of the Council on the 17th, day of October, 1983 commencing at the

hour of 7:30 o'clock p.m., at the Wilsonville City Hall.



DEANNA J. THOM, City Recorder

ENACTED by the Council on the 17th day of  
October \_\_\_\_\_, 1983, by the following votes:

YEAS: 4 NAYS 0

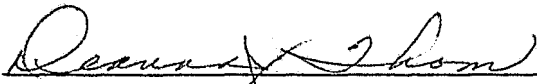

DEANNA J. THOM, City Recorder

DATED and signed by the Mayor this 19th day of

October, 1983.

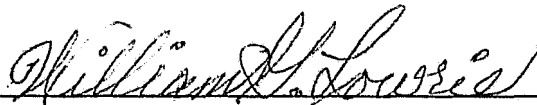

WILLIAM G. LOWRIE, Mayor

CITY OF WILSONVILLE

# MEMO

October 3, 1983

DATE

TO: Mayor and City Council

FROM: Daniel O. Potter, City Administrator

SUBJECT: Request for Segregation of Assessment in  
Local Improvement District

Ordinance No. 190 levied an assessment for the Boeckman Creek Sewer Improvement District (Local Improvement District No. 3) to B & B Development Company on property now known as the Boeckman Creek Condos. This assessment totals \$5,749.66 plus accrued interest and was levied on the whole of the property and the 56 condominiums that exist on the property. The property was described as Tax Lot 2703 in the SE 1/4, SW 1/4, Section 13 T3S, R1W.

Ordinance No. 190 was enacted on August 17, 1981. No payment has been made on the assessment as of this date. The property is potentially subject to foreclosure for non-payment of assessment and the interest that has accrued on the assessment.

B & B Development Company has no further interest in the property. The condominiums have been sold to individuals and corporations and each condominium unit has a separate tax lot description now.

As a means of resolving the problem of non-payment of the assessment short of foreclosure, the city staff made contact with the current owners of the property for the purpose of determining some process for the assessment to be paid in full, or the payments being brought to a current status.

We now have correspondence from the Boeckman Creek Homeowners Association, a non-profit corporation, who agree to make payment of the assessment over a two-year period with payments to be made quarterly with such payment to be first applied to the interest, and then to principal reduction.

The present assessment is against the total of the property, and any sale of any condominium at the time of a lien search will show the total of the assessment, plus interest as being due and payable.

The individual owners of the condominiums wish to have the assessment apportioned to the individual property. The purpose of this would be to enable an individual owner to pay the assessment relating to an individual unit and then be able to provide clear title to the individual condominium unit. Segregation of the property by condominium unit description would not diminish the value of the property in that every individual unit has adequate assessed value to bond the total of the assessment.

Attached hereto as Exhibit 1 is a map showing the area of the original assessment.

Also attached is Exhibit 2 being a copy of the Assessor's Tax Roll with each of the 56 units specifically and individually described. The base tax lot code is 31W13CD90 followed by a building identification, and a unit designation.

The principal assessment segregation for the 56 properties involved when related to the tax lot code is as follows - all plus accrued interest from date of assessment at 11.5% per annum.

31W13CD90	A01	-	\$110.08	31W3CD90	C36	-	\$105.67
	A02	-	110.08	(cont.)	C37	-	105.67
	A03	-	110.08		C38	-	105.67
	A04	-	110.08		C39	-	105.67
	A05	-	110.08		C40	-	105.67
	A06	-	110.08		C41	-	105.67
	A07	-	110.08		C42	-	105.67
	A08	-	110.08		C43	-	105.67
	A09	-	110.08		C44	-	105.67
	A10	-	110.08		C45	-	105.67
31W13CD90	B11	-	\$110.08		C46	-	105.67
	B12	-	110.08		C47	-	105.67
	B13	-	110.08		C48	-	105.67
	B14	-	110.08	31W13CD90	D49	-	\$105.66
	B15	-	110.08		D50	-	105.66
	B16	-	110.08		D51	-	105.66
	B17	-	110.08		D52	-	105.66
	B18	-	110.08		D53	-	105.66
	B19	-	110.08		D54	-	105.66
	B20	-	110.08		D55	-	105.66
	B21	-	110.08		D56	-	105.66
	B22	-	110.08				
31W13CD90	C23	-	\$ 79.19				
	C24	-	79.19				
	C25	-	79.19				
	C26	-	79.19				
	C27	-	79.19				
	C28	-	79.19				
31W13CD90	C29	-	\$ 79.19				
	C30	-	79.19				
	C31	-	79.19				
	C32	-	79.19				
	C33	-	105.67				
	C34	-	105.67				
	C35	-	105.67				

Mayor and City Council  
October 3, 1983  
Page 3

Total All Assessments    \$5,749.66  
Total Original Assessments    \$5,749.66

The apportionment of the assessment has been made based on the square footage of the assessment, and the proportional interest in the common area. Exhibit 3 shows the common area share per unit.

The review of the proposed reapportionment of assessment did include a physical viewing of the property to determine if there were any problems relating to terrain, access, streets, or other problems. The review also took into consideration a review of the Zoning Ordinance, a review of Ordinance 190 assessing the property, and the values of the properties. Since this is an existing property, no physical changes are made. Exhibit 2 clearly shows adequate assessed value for each unit proposed to be segregated.

Recommendation: I recommend that the City Council reapportion the assessment for each of the condominium units as set forth above.

This reapportionment shall be subject to accrued interest since the inception of the assessment. No payments have been made.

Respectfully submitted,



Daniel O. Potter

DOP/fr

Attachments

EXHIBIT 1



SE.1/4 S.W.1/4 SEC. 13 T3S R.  
CLACKAMAS COUNTY

1" = 40'

COURTSIDE DRIVE

BOECKMAN  
CREEK  
CONDOMINIUM

3-23  
2524

NOTE:  
Buildings (C) & (D) Lower Units Odd Nos.  
Upper Units Even Nos.

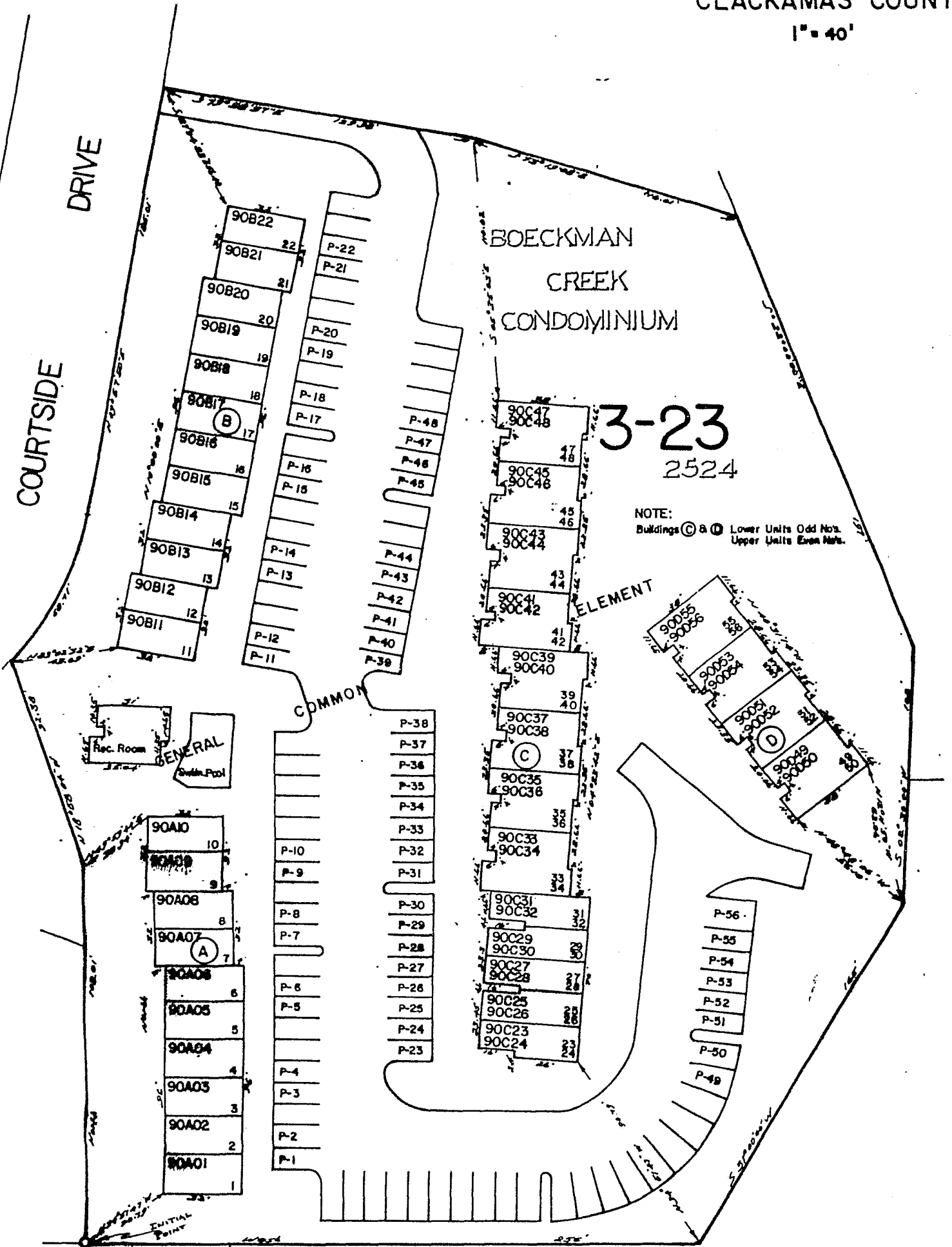

EXHIBIT 2

344

31W13CD90A01  
SERIAL 1114527

03/28/83

WILSONVILLE 003-023  
TIME RUN 22:08

80-45940

49,900 49,900

MAILING SCHNEIDER JOHN F 101 241 80 05 81 38  
& VICTORIA A 2524 BOECKMAN CRK CONDO  
29750 SW COURTSIDE DR #1 UNIT 1 BLDG A  
WILSONVILLE OR 97070

EXMPT FU POT. SWO TIMBER TRANS DIV. ORIG LOT  
3/06/81

SITUS

345

31W13CD90A02  
SERIAL 1114535

03/28/83

WILSONVILLE 003-023  
TIME RUN 22:08

01624-81 81-00967

49,900 49,900

MAILING WATT MICHAEL H 101 241 80 05 81 38  
29750 SW COURTSIDE DR #2 2524 BOECKMAN CRK CONDO  
WILSONVILLE OR 97070 UNIT 2 BLDG A

EXMPT FU POT. SWO TIMBER TRANS DIV. ORIG LOT  
3/25/81

SITUS

346

31W13CD90A03  
SERIAL 1114543

03/28/83

WILSONVILLE 003-023  
TIME RUN 22:08

01496-81 80-48406

49,900 49,900

MAILING SO SOON CHUN 101 241 80 05 81 38  
#3 29750 SW COURTSIDE DR 2524 BOECKMAN CRK CONDO  
WILSONVILLE OR 97070 UNIT 3 BLDG A

EXMPT FU POT. SWO TIMBER TRANS DIV. ORIG LOT  
3/06/81

SITUS

347

31W13CD90A04  
SERIAL 1114551

03/28/83

WILSONVILLE 003-023  
TIME RUN 22:08

80-46779

49,900 49,900

MAILING BERNERT TIMOTHY J 101 241 80 05 81 38  
29750 SW COURTSIDE DR #4 2524 BOECKMAN CRK CONDO  
WILSONVILLE OR 97070 UNIT 4 BLDG A

EXMPT FU POT. SWD TIMBER TRANS DIV. ORIG LOT  
3/06/81

SITUS

348

31W13CD90A05  
SERIAL 1114569

03/28/83

WILSONVILLE 003-023  
TIME RUN 22:08

01733-81 81-04814

49,900 49,900

MAILING NELSON ALBERT L 101 241 80 05 81 38  
29750 SW COURTSIDE DR #5 2524 BOECKMAN CRK CONDO  
WILSONVILLE OR 97070 UNIT 5 BLDG A

EXMPT FU POT. SWD TIMBER TRANS DIV. ORIG LOT  
3/28/81

SITUS

349

31W13CD90A06  
SERIAL 1114577

03/28/83

WILSONVILLE 003-023  
TIME RUN 22:08

80-46148

49,900 49,900

MAILING BIGGS BRET P 101 241 80 05 81 38 HO ENTIRE  
29750 SW COURTSIDE DR #6 2524 BOECKMAN CRK CONDO  
WILSONVILLE OR 97070 UNIT 6 BLDG A

EXMPT FU POT. SWD TIMBER TRANS DIV. ORIG LOT  
6/02/82

SITUS

350

31W13CD90A07  
SERIAL 1114585

03/28/83

WILSONVILLE 003-023  
TIME RUN 22:08

01733-81 81-03302

49,900 49,900

MAILING COFFEL LANCE F 101 241 80 05 81 38  
29750 SW COURTSIDE DR #7 2524 BOECKMAN CRK CONDO  
WILSONVILLE OR 97070 UNIT 7 BLDG A

EXMPT FU PDT. SWD TIMBER TRANS DIV. ORIG LOT  
3/28/81

SITUS

351

31W13CD90A08  
SERIAL 1114593

03/28/83

WILSONVILLE 003-023  
TIME RUN 22:08

01624-81 81-01980

49,900 49,900

MAILING FAGG ALLAN H 101 241 80 05 81 38 HO ENTIRE  
29750 SW COURTSIDE DR #8 2524 BOECKMAN CRK CONDO  
WILSONVILLE OR 97070 UNIT 8 BLDG A

EXMPT FU PDT. SWD TIMBER TRANS DIV. ORIG LOT  
6/02/82

SITUS

352

31W13CD90A09  
SERIAL 1114608

03/28/83

WILSONVILLE 003-023  
TIME RUN 22:08

01733-81 81-03686

49,900 49,900

MAILING WATSON DAVID E 101 241 80 05 81 38 HO ENTIRE  
& BARBARA P 2524 BOECKMAN CRK CONDO  
29750 SW COURTSIDE DR #9 UNIT 9 BLDG A  
WILSONVILLE OR 97070

EXMPT FU PDT. SWD TIMBER TRANS DIV. ORIG LOT  
7/02/81

SITUS

353

31W13CD90A10  
SERIAL 1114616

03/28/83

WILSONVILLE  
TIME RUN

003-023  
22:08

02986-82 82-06248

49,900 49,900

MAILING G P PROPERTIES 101 241 80 05 81 38  
1099 SW COLUMBIA ST 2524 BOECKMAN CRK CONDO  
PORTLAND OR 97201 UNIT 10 BLDG A

EXMPT FU POT. SWO TIMBER TRANS DIV. ORIG LOT  
4/19/82

SITUS

354

31W13CD90B11  
SERIAL 1114624

03/28/83

WILSONVILLE  
TIME RUN

003-023  
22:08

03247-81 81-15350

49,900 49,900

MAILING HIGGINS THOMAS A 101 241 80 05 81 38  
OLIVER ANN E 2524 BOECKMAN CRK CONDO  
29650 SW COURTSIDE DR 11 UNIT 11 BLDG B  
WILSONVILLE OR 97070

EXMPT FU POT. SWO TIMBER TRANS DIV. ORIG LOT  
6/11/81

SITUS

355

31W13CD90B12  
SERIAL 1114632

03/28/83

WILSONVILLE  
TIME RUN

003-023  
22:08

03812-81 81-19490

49,900 49,900

MAILING MINER PATRICIA M 101 241 80 05 81 38  
29650 SW COURTSIDE DR 12 UNIT 12 BLDG B  
WILSONVILLE OR 97070

EXMPT FU POT. SWO TIMBER TRANS DIV. ORIG LOT  
7/24/81

SITUS

356

31W13CD90B13  
SERIAL 1114640

03/28/83

WILSONVILLE 003-023  
TIME RUN 22:08

01733-81 81-02769

49,900 49,900

MAILING COFFEL SHANNON BETH 101 241 80 05 81 38  
29650 SW COURTSIDE DR 13 2524 BOECKMAN CRK CONDO  
WILSONVILLE OR 97070 UNIT 13 BLDG B

EXMPT FU POT. SWO TIMBER TRANS DIV. ORIG LOT  
3/28/81

SITUS

357

31W13CD90B14  
SERIAL 1114658

03/28/83

WILSONVILLE 003-023  
TIME RUN 22:08

02077-83 81-01292

49,900 49,900

MAILING SANGRONIZ ROBERT LEON 101 241 80 05 81 38 HO ENTIRE  
& KATHERINE DENNETT 2524 BOECKMAN CRK CONDO  
29650 SW COURTSIDE DR #14 UNIT 14 BLDG B  
WILSONVILLE OR 97070

EXMPT FU POT. SWO TIMBER TRANS DIV. ORIG LOT  
2/22/83

SITUS

358

31W13CD90B15  
SERIAL 1114666

03/28/83

WILSONVILLE 003-023  
TIME RUN 22:08

02986-82 82-06248

49,900 49,900

MAILING G P PROPERTIES 101 241 80 05 81 38  
1099 SW COLUMBIA ST 2524 BOECKMAN CRK CONDO  
PORTLAND OR 97201 UNIT 15 BLDG B

EXMPT FU POT. SWO TIMBER TRANS DIV. ORIG LOT  
4/19/82

SITUS

359

31W13CD90B16  
SERIAL 1114674

03/28/83

WILSONVILLE  
TIME RUN

003-023  
22:08

01733-81 81-04151

49,900 49,900

MAILING DUGAN KELLY JAMES 101 241 80 05 81 38  
29650 SW COURTSIDE DR 16 2524 BOECKMAN CRK CONDO  
WILSONVILLE OR 97070 UNIT 16 BLDG B

EXMPT FU POT. SWO TIMBER TRANS DIV. ORIG LOT  
3/28/81

SITUS

360

31W13CD90B17  
SERIAL 1114682

03/28/83

WILSONVILLE  
TIME RUN

003-023  
22:08

02635-81 81-09570

49,900 49,900

MAILING PALUMBO DANIEL DAVID 101 241 80 05 81 38 HO ENTIRE  
#17 29650 SW COURTSIDE 2524 BOECKMAN CRK CONDO  
WILSONVILLE OR 97070 UNIT 17 BLDG B

EXMPT FU POT. SWO TIMBER TRANS DIV. ORIG LOT  
5/11/82

SITUS

361

31W13CD90B18  
SERIAL 1114690

03/28/83

WILSONVILLE  
TIME RUN

003-023  
22:08

02777-81 81-11323

49,900 49,900

MAILING YOUNG LEORA R 101 241 80 05 81 38  
29650 SW CRTSIDE DR #18 2524 BOECKMAN CRK CONDO  
WILSONVILLE OR 97070 UNIT 18 BLDG B

EXMPT FU POT. SWO TIMBER TRANS DIV. ORIG LOT  
5/14/81

SITUS



362

31W13CD90819  
SERIAL 1114705

03/28/83

WILSONVILLE 003-023  
TIME RUN 22:08

03535-81 81-18439

49,900 49,900

MAILING BRAMAN MARK JAMES 101 241 80 05 81 38 HO ENTIRE  
29650 SW COURTSIDE DR 2524 BOECKMAN CRK CONDO  
WILSONVILLE OR 97070 UNIT 19 BLDG 8

EXMPT FU POT. SWO TIMBER TRANS DIV. ORIG LOT  
4/22/82

SITUS

363

31W13CD90820  
SERIAL 1114713

03/28/83

WILSONVILLE 003-023  
TIME RUN 22:08

02184-81 81-07082

49,900 49,900

MAILING HEGRENES CRAIG A 101 241 80 05 81 38 HO ENTIRE  
SUITE #305 2524 BOECKMAN CRK CONDO  
#20 29650 SW COURTSIDE UNIT 20 BLDG 8  
WILSONVILLE OR 97070

EXMPT FU POT. SWO TIMBER TRANS DIV. ORIG LOT  
6/02/82

SITUS

364

31W13CD90821  
SERIAL 1114721

03/28/83

WILSONVILLE 003-023  
TIME RUN 22:08

03364-82 82-02748

49,900 49,900

MAILING HARRINGTON ROBERT E 101 241 80 05 81 38  
MICHAEL SCHAEFFER 2524 BOECKMAN CRK CONDO  
SUITE 1900 1001 SW 5TH UNIT 21 BLDG 8  
PORTLAND OR 97204

EXMPT FU POT. SWO TIMBER TRANS DIV. ORIG LOT  
5/24/82

SITUS

365

31W13CD90B22  
SERIAL 1114739

03/28/83

WILSONVILLE 003-023  
TIME RUN 22:08

00442-82

81-25473

49,900

49,900

MAILING HARDY WEBSTER A 101 241 80 05 81 38  
29650 SW COURTSIDE DR #22 2524 BOECKMAN CRK CONDO  
WILSONVILLE OR 97070 UNIT 22 BLDG B

EXMPT FU POT. SWO TIMBER TRANS DIV. ORIG LOT  
8/27/81

SITUS

366

31W13CD90C23  
SERIAL 1114747

03/28/83

WILSONVILLE 003-023  
TIME RUN 22:08

01496-81

80-48250

35,900

35,900

MAILING SOHLSTROM STEVEN D 101 241 80 05 81 38 HO ENTIRE  
#23 29700 SW COURTSIDE 2524 BOECKMAN CRK CONDO  
WILSONVILLE OR 97070 UNIT 23 BLDG C

EXMPT FU POT. SWO TIMBER TRANS DIV. ORIG LOT  
7/02/81

SITUS

367

31W13CD90C24  
SERIAL 1114755

03/28/83

WILSONVILLE 003-023  
TIME RUN 22:08

01496-81

80-48526

35,900

35,900

MAILING LEE TIMOTHY R 101 241 80 05 81 38  
#24 29700 SW COURTSIDE 2524 BOECKMAN CRK CONDO  
WILSONVILLE OR 97070 UNIT 24 BLDG C

EXMPT FU POT. SWO TIMBER TRANS DIV. ORIG LOT  
3/06/81

SITUS

368

31W13CD90C25  
SERIAL 1114763

03/28/83

WILSONVILLE 003-023  
TIME RUN 22:08

02986-82 82-06248

35,900 35,900

MAILING G P PROPERTIES 101 241 80 05 81 38  
1099 SW COLUMBIA ST 2524 BOECKMAN CRK CONDO  
PORTLAND OR 97201 UNIT 25 BLDG C

EXMPT FU POT. SWD TIMBER TRANS DIV. ORIG LOT  
4/19/82

SITUS

369

31W13CD90C26  
SERIAL 1114771

03/28/83

WILSONVILLE 003-023  
TIME RUN 22:08

00442-82 81-25107

35,900 35,900

MAILING GRAMSON KEVIN 101 241 80 05 81 38  
29700 SW COURTSIDE DR#26 2524 BOECKMAN CRK CONDO  
WILSONVILLE OR 97070 UNIT 26 BLDG C

EXMPT FU POT. SWD TIMBER TRANS DIV. ORIG LOT  
8/27/81

SITUS

370

31W13CD90C27  
SERIAL 1114789

03/28/83

WILSONVILLE 003-023  
TIME RUN 22:08

02986-82 82-06248

35,900 35,900

MAILING G P PROPERTIES 101 241 80 05 81 38  
1099 SW COLUMBIA ST 2524 BOECKMAN CRK CONDO  
PORTLAND OR 97201 UNIT 27 BLDG C

EXMPT FU POT. SWD TIMBER TRANS DIV. ORIG LOT  
4/19/82

SITUS

371

31W13CD90C28  
SERIAL 1114797

03/28/83

WILSONVILLE 003-023  
TIME RUN 22:08

00272-82

81-23134

35,900

35,900

MAILING ALLEN STEPHEN P  
& MARILEE G  
16662 FOX GLEN RD  
RIVERSIDE CA 92504

101 241 80 05 81 38  
2524 BOECKMAN CRK CONDO  
UNIT 28 BLDG C

EXMPT FU POT. SWO TIMBER TRANS DIV. ORIG LOT  
8/18/81

SITUS

372

31W13CD90C29  
SERIAL 1114802

03/28/83

WILSONVILLE 003-023  
TIME RUN 22:08

02986-82

82-06248

35,900

35,900

MAILING G P PROPERTIES  
1099 SW COLUMBIA ST  
PORTLAND OR 97201

101 241 80 05 81 38  
2524 BOECKMAN CRK CONDO  
UNIT 29 BLDG C

EXMPT FU POT. SWO TIMBER TRANS DIV. ORIG LOT  
4/19/82

SITUS

373

31W13CD90C30  
SERIAL 1114810

03/28/83

WILSONVILLE 003-023  
TIME RUN 22:08

80-46146

35,900

35,900

MAILING LOCKE DONNA L  
29700 SW COURTSIDE DR 30  
WILSONVILLE OR 97070

101 241 80 05 81 38 HO ENTIRE  
2524 BOECKMAN CRK CONDO  
UNIT 30 BLDG C

EXMPT FU POT. SWO TIMBER TRANS DIV. ORIG LOT  
5/11/82

SITUS

374

31W13CD90C31  
SERIAL 1114828

03/28/83

WILSONVILLE 003-023  
TIME RUN 22:08

02986-82 82-06248

35,900 35,900

MAILING G P PROPERTIES 101 241 80 05 81 38  
1099 SW COLUMBIA ST 2524 BOECKMAN CRK CONDO  
PORTLAND OR 97201 UNIT 31 BLDG C

EXMPT FU POT. SWO TIMBER TRANS DIV. ORIG LOT  
4/19/82

SITUS

375

31W13CD90C32  
SERIAL 1114836

03/28/83

WILSONVILLE 003-023  
TIME RUN 22:08

03364-82 82-02748

35,900 35,900

MAILING HARRINGTON ROBERT E 101 241 80 05 81 38  
9221 SW BARBUR BLVD #304 2524 BOECKMAN CRK CONDO  
PORTLAND OR 97219 UNIT 32 BLDG C

EXMPT FU POT. SWO TIMBER TRANS DIV. ORIG LOT  
5/24/82

SITUS

376

31W13CD90C33  
SERIAL 1114844

03/28/83

WILSONVILLE 003-023  
TIME RUN 22:08

02986-82 82-06248

47,900 47,900

MAILING G P PROPERTIES 101 241 80 05 81 38  
1099 SW COLUMBIA ST 2524 BOECKMAN CRK CONDO  
PORTLAND OR 97201 UNIT 33 BLDG C

EXMPT FU POT. SWO TIMBER TRANS DIV. ORIG LOT  
4/19/82

SITUS

377

31W13CD90C34  
SERIAL 1114852

03/28/83

WILSONVILLE 003-023  
TIME RUN 22:08

03364-82 82-02748

47,900 47,900

HARRINGTON ROBERT E 101 241 80 05 81 38  
MICHAEL SCHAEFFER 2524 BOECKMAN CRK CONDO  
MAILING SUITE 1900 1001 SW 5TH 97204 UNIT 34 BLDG C  
PORTLAND OR

EXMPT FU POT. SWD TIMBER TRANS DIV. ORIG LOT

5/24/82

SITUS

378

31W13CD90C35  
SERIAL 1114860

03/28/83

WILSONVILLE 003-023  
TIME RUN 22:08

02986-82 82-06248

47,900 47,900

G P PROPERTIES 101 241 80 05 81 38  
MAILING 1099 SW COLUMBIA ST 2524 BOECKMAN CRK CONDO  
PORTLAND OR 97201 UNIT 35 BLDG C

EXMPT FU POT. SWD TIMBER TRANS DIV. ORIG LOT

4/19/82

SITUS

379

31W13CD90C36  
SERIAL 1114878

03/28/83

WILSONVILLE 003-023  
TIME RUN 22:08

03364-82 82-02748

47,900 47,900

HARRINGTON ROBERT E 101 241 80 05 81 38  
MAILING 9221 SW BARBUR BLVD #304 2524 BOECKMAN CRK CONDO  
PORTLAND OR 97219 UNIT 36 BLDG C

EXMPT FU POT. SWC TIMBER TRANS DIV. ORIG LOT

5/24/82

SITUS

380

31W13CD90C37  
SERIAL 1114886

03/28/83

WILSONVILLE 003-023  
TIME RUN 22:08

02986-82 82-06248

47,900 47,900

MAILING G P PROPERTIES 101 241 80 05 81 38  
1099 SW COLUMBIA ST 2524 BOECKMAN CRK CONDO  
PORTLAND OR 97201 UNIT 37 BLDG C

EXMPT FU POT. SWO TIMBER TRANS DIV. ORIG LOT  
4/19/82

SITUS

381

31W13CD90C38  
SERIAL 1114894

03/28/83

WILSONVILLE 003-023  
TIME RUN 22:08

02986-82 82-06248

47,900 47,900

MAILING G P PROPERTIES 101 241 80 05 81 38  
1099 SW COLUMBIA ST 2524 BOECKMAN CRK CONDO  
PORTLAND OR 97201 UNIT 38 BLDG C

EXMPT FU POT. SWO TIMBER TRANS DIV. ORIG LOT  
4/19/82

SITUS

382

31W13CD90C39  
SERIAL 1114909

03/28/83

WILSONVILLE 003-023  
TIME RUN 22:08

02986-82 82-06248

47,900 47,900

MAILING G P PROPERTIES 101 241 80 05 81 38  
1099 SW COLUMBIA ST 2524 BOECKMAN CRK CONDO  
PORTLAND OR 97201 UNIT 39 BLDG C

EXMPT FU POT. SWO TIMBER TRANS DIV. ORIG LOT  
4/19/82

SITUS

386

31W13CD90C43  
SERIAL 1114941

03/28/83

WILSONVILLE  
TIME RUN

003-023  
22:08

02986-82 82-06248

47,900

47,900

MAILING G P PROPERTIES 101 241 80 05 81 38  
1099 SW COLUMBIA ST 2524 BOECKMAN CRK CONDO  
PORTLAND OR 97201 UNIT 43 BLDG C

EXMPT FU POT. SWO TIMBER TRANS DIV. ORIG LOT  
4/19/82

SITUS

387

31W13CD90C44  
SERIAL 1114959

03/28/83

WILSONVILLE  
TIME RUN

003-023  
22:08

02986-82 82-06248

47,900

47,900

MAILING G P PROPERTIES 101 241 80 05 81 38  
1099 SW COLUMBIA ST 2524 BOECKMAN CRK CONDO  
PORTLAND OR 97201 UNIT 44 BLDG C

EXMPT FU POT. SWO TIMBER TRANS DIV. ORIG LOT  
4/19/82

SITUS

388

31W13CD90C45  
SERIAL 1114967

03/28/83

WILSONVILLE  
TIME RUN

003-023  
22:08

02986-82 82-06248

47,900

47,900

MAILING G P PROPERTIES 101 241 80 05 81 38  
1099 SW COLUMBIA ST 2524 BOECKMAN CRK CONDO  
PORTLAND OR 97201 UNIT 45 BLDG C

EXMPT FU POT. SWO TIMBER TRANS DIV. ORIG LOT  
4/19/82

SITUS



389

31W13CD90C46  
SERIAL 1114975

03/28/83

WILSONVILLE 003-023  
TIME RUN 22:08

00523-82 81-28145

47,900 47,900

MAILING SWANTKO MICHAEL T 101 241 80 05 81 38 HO ENTIRE  
& CHERYL L 2524 BOECKMAN CRK CONDO  
29700 SW COURTSIDE DR #46 WILSONVILLE OR 97070 UNIT 46 BLDG C

EXMPT FU POT. SWO TIMBER TRANS DIV. ORIG LOT  
6/02/82

SITUS

390

31W13CD90C47  
SERIAL 1114983

03/28/83

WILSONVILLE 003-023  
TIME RUN 22:08

03247-81 81-16619

47,900 47,900

MAILING HOFFMAN LEROY E 101 241 80 05 81 38  
& COLEEN 2524 BOECKMAN CRK CONDO  
13549 JASON LEE DR OREGON CITY OR 97045 UNIT 47 BLDG C

EXMPT FU POT. SWO TIMBER TRANS DIV. ORIG LOT  
6/11/81

SITUS

391

31W13CD90C48  
SERIAL 1114991

03/28/83

WILSONVILLE 003-023  
TIME RUN 22:08

01733-81 81-04153

47,900 47,900

MAILING SUTTELL ANGELA L 101 241 80 05 81 38  
29700 SW COURTSIDE DR 48 WILSONVILLE OR 97070 2524 BOECKMAN CRK CONDO  
UNIT 48 BLDG C

EXMPT FU POT. SWO TIMBER TRANS DIV. ORIG LOT  
3/28/81

SITUS

392

31W13CD90D49  
SERIAL 1115002

03/28/83

WILSONVILLE 003-023  
TIME RUN 22:08

01624-81 81-01290

47,900 47,900

MAILING LAMPERT MARC JAY 101 241 80 05 81 38  
29720 SW COURTSIDE DR#49 2524 BOECKMAN CRK CONDO  
WILSONVILLE OR 97070 UNIT 49 BLDG D

EXMPT FU POT. SWO TIMBER TRANS DIV. ORIG LOT  
3/25/81

SITUS

393

31W13CD90D50  
SERIAL 1115010

03/28/83

WILSONVILLE 003-023  
TIME RUN 22:08

03812-81 81-21777

47,900 47,900

MAILING KOENIG JODY M 101 241 80 05 81 38  
29720 SW COURTSIDE-#50 2524 BOECKMAN CRK CONDO  
WILSONVILLE OR 97070 UNIT 50 BLDG D

EXMPT FU POT. SWO TIMBER TRANS DIV. ORIG LOT  
7/24/81

SITUS

394

31W13CD90D51  
SERIAL 1115028

03/28/83

WILSONVILLE 003-023  
TIME RUN 22:08

03535-81 81-16916

47,900 47,900

MAILING GAYLORD TODD E 101 241 80 05 81 38  
DUNWOODIE RONDA K 2524 BOECKMAN CRK CONDO  
29720 SW COURTSIDE DR#51 UNIT 51 BLDG D  
WILSONVILLE OR 97070

EXMPT FU POT. SWO TIMBER TRANS DIV. ORIG LOT  
7/08/81

SITUS

395

31W13CD90D52  
SERIAL 1115036

03/28/83

WILSONVILLE 003-023  
TIME RUN 22:08

80-47054

47,900 47,900

MAILING LOCKER LINDA B 101 241 80 05 81 38  
29720 SW COURTSIDE DR-52 2524 BOECKMAN CRK CONDO  
WILSONVILLE OR 97070 UNIT 52 BLDG D

EXMPT FU POT. SWO TIMBER TRANS DIV. ORIG LOT  
3/06/81

SITUS

396

31W13CD90D53 \*\*EXEMPT\*\* 03/28/83 WILSONVILLE 003-023  
SERIAL 1115044 TIME RUN 22:08

EX

82-11524

ST

47,900 47,900

MAILING STATE OF OREGON 101 241 80 05 81 38  
DEPT OF COMMERCE 2524 BOECKMAN CRK CONDO  
LABOR & INDUSTRIES BLDG UNIT 53 BLDG D  
SALEM OR 97310

EXMPT FU POT. SWO TIMBER TRANS DIV. ORIG LOT  
1982 5/25/82

SITUS

397

31W13CD90D54 03/28/83 WILSONVILLE 003-023  
SERIAL 1115052 TIME RUN 22:08

02986-82 82-05874 47,900 47,900

MAILING PAISLEY LINDA L 101 241 80 05 81 38 HO ENTIRE  
29720 SW COURTSIDE DR-54 2524 BOECKMAN CRK CONDO  
WILSONVILLE OR 97070 UNIT 54 BLDG D

EXMPT FU POT. SWO TIMBER TRANS DIV. ORIG LOT  
7/26/82

SITUS

398

31W13CD90D55  
SERIAL 1115060

03/28/83

WILSONVILLE 003-023  
TIME RUN 22:08

00831-82 81-33583

47,900 47,900

GROSHONG DANIEL J 101 241 80 05 81 38  
COMGER PATRICIA A 2524 BOECKMAN CRK CONDO  
XGROSHONG DANIEL J UNIT 55 BLDG D  
MAILING 29700 SW COURTSIDE DR #55  
WILSONVILLE OR 97070

EXMPT FU POT. SWC TIMBER TRANS DIV. ORIG LOT  
12/02/81

SITUS

399

31W13CD90D56  
SERIAL 1115078

03/28/83

WILSONVILLE 003-023  
TIME RUN 22:08

02022-83 83-00695

47,900 47,900

WILLAMETTE S/L ASSN 101 241 80 05 81 38  
MAILING #56 29720 SW COURTSIDE 2524 BOECKMAN CRK CONDO  
WILSONVILLE OR 97070 UNIT 56 BLDG D

EXMPT FU POT. SWC TIMBER TRANS DIV. ORIG LOT  
2/15/83

SITUS

EXHIBIT 3

(Method: Relative Initial Unit Price)

<u>Building</u> <u>A</u>	<u>Floor</u>	<u>Age of owner-</u> <u>ship in general</u>	<u>Con-</u> <u>crete</u>	<u>Wood</u>	<u>Fire-</u> <u>place</u>	<u>Park-</u> <u>ing</u>
<u>Unit</u>		<u>common elements</u>	<u>Patio</u>	<u>Deck</u>		
1	townhouse	1.914518109	1		1	1
2	townhouse	1.914518109	2		2	2
3	townhouse	1.914518109	3		3	3
4	townhouse	1.914518109	4		4	4
5	townhouse	1.914518109	5		5	5
6	townhouse	1.914518109	6		6	6
7	townhouse	1.914518109	7		7	7
8	townhouse	1.914518109	8		8	8
9	townhouse	1.914518109	9		9	9
10	townhouse	1.914518109	10		10	10
<b>Building B</b>						
<u>Unit</u>						
11	townhouse	1.914518109	11		11	11
12	townhouse	1.914518109	12		12	12
13	townhouse	1.914518109	13		13	13
14	townhouse	1.914518109	14		14	14
15	townhouse	1.914518109	15		15	15
16	townhouse	1.914518109	16		16	16
17	townhouse	1.914518109	17		17	17
18	townhouse	1.914518109	18		18	18
19	townhouse	1.914518109	19		19	19
20	townhouse	1.914518109	20		20	20
21	townhouse	1.914518109	21		21	21
22	townhouse	1.914518109	22		22	22
<b>Building C</b>						
<u>Unit</u>						
23	first	1.377378759		23		23
24	second	1.377378759		24		24
25	first	1.377378759		25		25
26	second	1.377378759		26		26
27	first	1.377378759		27		27
28	second	1.377378759		28		28
29	first	1.377378760		29		29
30	second	1.377378760		30		30
31	first	1.377378760		31		31
32	second	1.377378760		32		32
33	first	1.837783917		33	33	33
34	second	1.837783917		34	34	34
35	first	1.837783917		35	35	35
36	second	1.837783917		36	36	36
37	first	1.837783917		37	37	37
38	second	1.837783917		38	38	38

Building C	Floor	Age of owner- ship in general common elements	Con- crete Patio	Wood Deck	Fire- place	Park- ing
Unit						
39	first	1.837783917		39	39	39
40	second	1.837783917		40	40	40
41	first	1.837783917		41	41	41
42	second	1.837783917		42	42	42
43	first	1.837783917		43	43	43
44	second	1.837783917		44	44	44
45	first	1.837783917		45	45	45
46	second	1.837783917		46	46	46
47	first	1.837783917		47	47	47
48	second	1.837783917		48	48	48

Building D	Floor	Age of owner- ship in general common elements	Con- crete Patio	Wood Deck	Fire- place	Park- ing
Unit						
49	first	1.837783917		49	49	49
50	second	1.837783917		50	50	50
51	first	1.837783917		51	51	51
52	second	1.837783917		52	52	52
53	first	1.837783917		53	53	53
54	second	1.837783917		54	54	54
55	first	1.837783917		55	55	55
56	second	1.837783917		56	56	56

STATE OF OREGON  
County of Clatsop

I, George D. Pearson, County Clerk, ex-officio  
Recorder, Conveyances and ex-officio Clerk  
of the Circuit Court of the State of Oregon, do  
hereby certify that the within instrument of writing was recorded for  
and recorded in the records of said county of

80 AUG 19 P 1:39

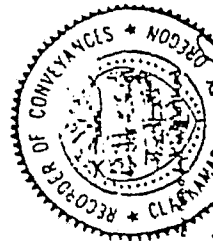

Witness my hand and the seal of said County of Clatsop, Oregon, this 19th day of August, 1980.  
George D. Pearson  
County Clerk  
Recording Certificate  
80 30916  
CCF-PC