

RESOLUTION NO. 2034

A RESOLUTION OF THE CITY OF WILSONVILLE ACKNOWLEDGING THE CITY COUNCIL'S RECEIPT AND RECOGNITION OF THE DECEMBER 2006 OFFICIAL ZONING MAP OF THE CITY OF WILSONVILLE AND AUTHORIZING THE MAYOR TO SIGN SAID MAP

WHEREAS, the current City of Wilsonville Official Zoning Map is dated October 1, 2003; and

WHEREAS, the City Council has, since 2003, approved and ordered several amendments to the Official Zoning Map as detailed in Exhibit B; and

WHEREAS, as a part of each zone amendment approved and ordered, the Planning Director is directed to change the Official Zoning Map in compliance with the zone change approval and order; and

WHEREAS, it is important that all versions of the City's Zoning Maps be as current a copy of the Official Zoning Map as practicable, so that questions are minimized in regard to the accuracy of said maps; and

WHEREAS, the City Council hereby directs that the Planning Director provide to the City Council for its information an updated Official Zoning Map in December of each subsequent year, together with a brief report as to the zone changes since the last December report; and

WHEREAS, the City Council finds the presentment of the updated Official Zoning Map to accurately reflect previously approved and ordered zone changes and as such is not a zone change within the meaning of ORS 215.223(3), and does not require notice.

NOW, THEREFORE, THE CITY OF WILSONVILLE RESOLVES AS FOLLOWS:

Section 1. Findings. The City Council adopts as findings, and conclusions, the foregoing recitals and the staff reports in this matter labeled as Exhibit B, as amended, which Exhibit is attached hereto and incorporated herein as if fully set forth.

Section 2. Order. Based upon the foregoing findings, the updated December 2006 City of Wilsonville Zoning Map, attached as Exhibit A and incorporated by reference herein, is hereby recognized as the current Official Zoning Map and the Mayor is authorized to sign said map.

Section 3. The Planning Director shall provide annually each December to the City Council for its receipt and recognition an Official Zoning Map updated by the zone changes from the previous December. This procedure is being provided to help ensure the Official Zoning Map be kept current at least annually. Failure to provide such an updated Official Zoning Map annually in December shall have no affect on any previously approved and ordered zone change.

Section 4. This resolution is effective upon adoption.

ADOPTED by the Wilsonville City Council at a regular meeting thereof this 18th day of December, 2006, and filed with the Wilsonville City Recorder this date.

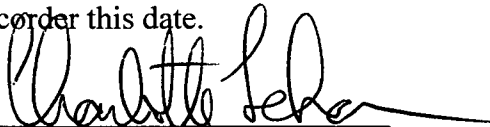
CHARLOTTE LEHAN, Mayor

ATTEST:

Sandra C. King, MMC, City Recorder

SUMMARY OF VOTES:

Mayor Lehan	Yes
Councilor Kirk	Yes
Councilor Holt	Excused
Councilor Knapp	Yes
Councilor Ripple	Yes

Attachments:

- Exhibit A – 2006 City of Wilsonville Official Zoning Map
- Exhibit B – Wilsonville Planning Staff Report to City Council dated December 18, 2006

Exhibit B
Resolution No. 2034

PLANNING DIVISION STAFF REPORT

TO: Honorable Mayor and City Council

FROM: Blaise Edmonds, Manager of Current Planning

DATE: December 18, 2006

SUBJECT: A Resolution Of The City Of Wilsonville Incorporating Approved Amendments To The Official Zoning Map, And Readopting The Official Zoning Map.

SUMMARY: The City Council has, since October 1, 2003, approved several amendments to the Official Zoning Map as detailed in Exhibit B to this staff report. The resolution proposed that all versions of the City's zoning Maps be copies of the Official Zoning Map, so that no questions are raised regarding the accuracy of said maps. Since the land use process in Wilsonville includes a significant number of zone map amendments as part of development proposals, the City should establish a procedure to readopt an updated Official Zoning Map in December of each subsequent year.

RECOMMENDATION: The City Council should adopt the proposed Resolution.

Zone Map Amendments - 2004 to Present

Resolution	Ordinance	Project	Change		Date of Adoption
			From	To	
	569	City	EFU	RA-H	2004
	570	Renaissance Homes	RA-H	PDR-3	
	572	Villebois	PF	V	10/4/2004
	577	John Smith - Morey's Court	RA-H	PDR-2	12/20/2004
	586	Villebois	EFU	V	5/16/2005
	598	Glenn Schroeder (DB05-0071)	RA-H	PDR-1	
	604	Doug Seely	RA-H	PDR-3	2/6/2006
	605	Jay Puppo	RA-H	PDC	2/28/2006
	611	Villebois		V	6/5/2006
	612	Villebois	PF	V	6/19/2006
	618	Tri-Met	RA-H	PDI	10/16/2006
	620	Villebois	EFU/PF	V	11/6/2006

Exhibit B to Staff Report

CITY OF WILSONVILLE

July 2004 to December 2006 Changes

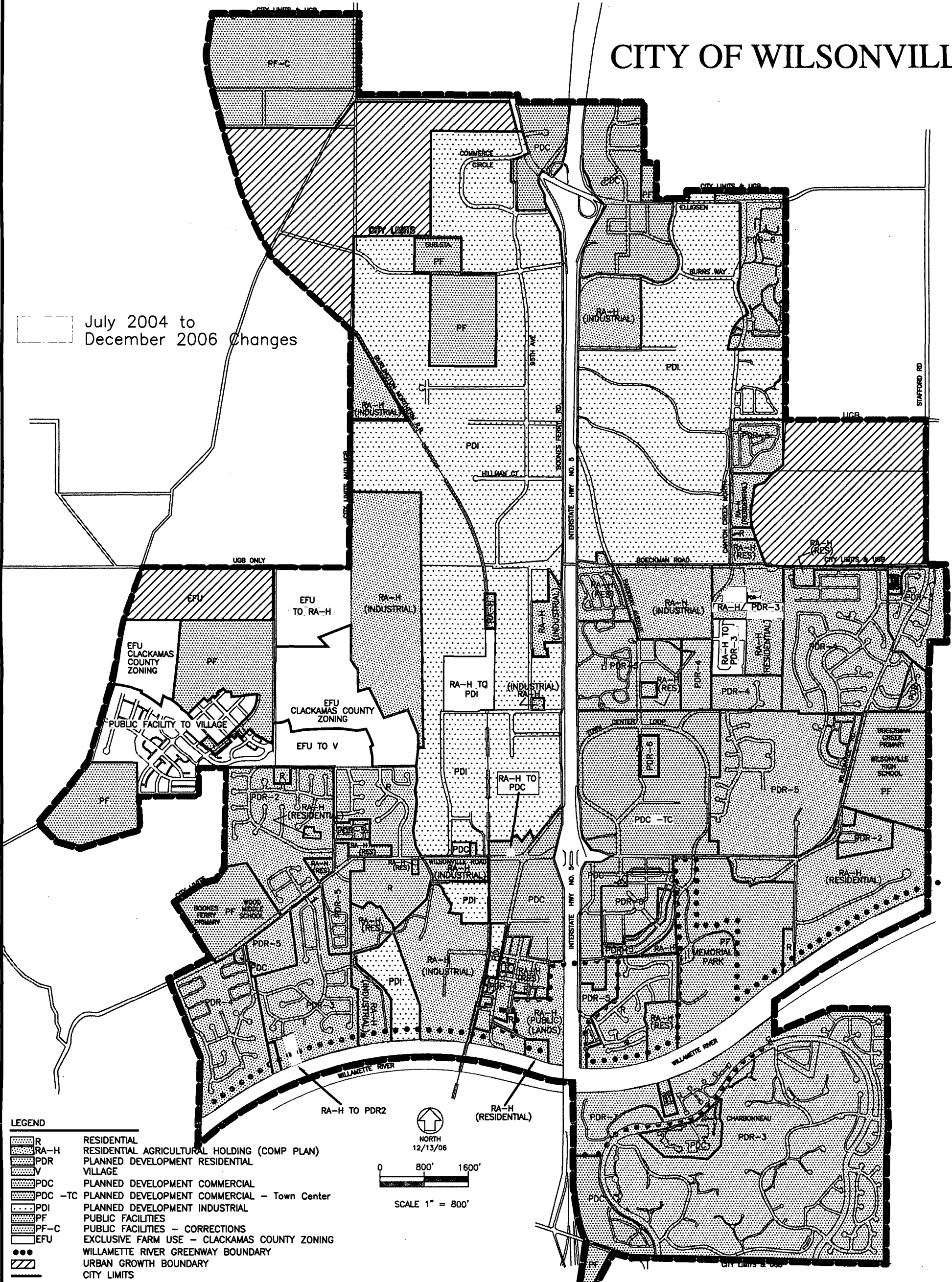

- LEGEND**
- R RESIDENTIAL
 - RA-H RESIDENTIAL AGRICULTURAL HOLDING (COMP PLAN)
 - PDR PLANNED DEVELOPMENT RESIDENTIAL
 - V VILLAGE
 - PDC PLANNED DEVELOPMENT COMMERCIAL
 - PDC -TC PLANNED DEVELOPMENT COMMERCIAL - Town Center
 - PDI PLANNED DEVELOPMENT INDUSTRIAL
 - PF PUBLIC FACILITIES
 - PF-C PUBLIC FACILITIES - CORRECTIONS
 - EFU EXCLUSIVE FARM USE - CLACKAMAS COUNTY ZONING
 - WILLAMETTE RIVER GREENWAY BOUNDARY
 - URBAN GROWTH BOUNDARY
 - CITY LIMITS

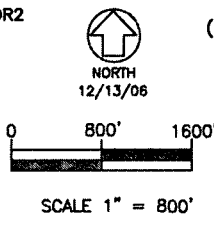

* Please refer to the separate Natural Resource Plan Map in the Planning Division to determine the boundaries of the Significant Resource Overlay Zone and the Old Town Overlay Zone.

OFFICIAL ZONING MAP

MAYOR _____ DATE _____
 ATTEST: _____ DATE _____
 CITY RECORDER _____ ORDINANCE NUMBER: _____

Exhibit A
 Resolution No. 2034