

RESOLUTION NO. 758

A RESOLUTION INITIATING THE VACATION OF PUBLIC UTILITY EASEMENTS IN THE WILSONVILLE MEADOWS SUBDIVISION, LOTS 1 THROUGH 51, AND SETTING A PUBLIC HEARING DATE.

WHEREAS, the Robert Randall Company has filed with the City a petition setting forth a description of the ground proposed to be vacated as attached in Exhibit "A" and "B"; and

WHEREAS, a sum sufficient to cover the cost of publication, posting and other anticipated expenses has been deposited with the City; and

WHEREAS, the Wilsonville City Council wishes to address this issue in a timely fashion.

NOW, THEREFORE, THE CITY OF WILSONVILLE RESOLVES AS FOLLOWS:

A public hearing regarding the vacation of public utility easements is scheduled for April 2, 1990 in Council Chambers at the Wilsonville City Hall.

ADOPTED by the Wilsonville City Council at a regular meeting thereof this 20th day of February 1990, and filed with the Wilsonville City Recorder this same date.

  
\_\_\_\_\_  
JOHN M. LUDLOW, Mayor

ATTEST:

  
\_\_\_\_\_  
VERA A. ROJAS, City Recorder

SUMMARY of Votes:

Mayor Ludlow	<u>Aye</u>
Councilor Edwards	<u>Aye</u>
Councilor Chandler	<u>Aye</u>
Councilor Clarke	<u>Aye</u>
Councilor Dant	<u>Aye</u>



City of  
**WILSONVILLE**  
in OREGON

30000 SW Town Center Loop E • PO Box 220  
Wilsonville, OR 97070  
(503) 682-1011

**COMMUNITY DEVELOPMENT DEPARTMENT**  
**MEMORANDUM**

**DATE:** FEBRUARY 14, 1990

**TO:** HONORABLE MAYOR AND CITY COUNCILORS

**THROUGH:** PETE WALL  
CITY MANAGER

**FROM:** STEVE STARNER *Starn*  
COMMUNITY DEVELOPMENT DIRECTOR

**RE:** VACATION OF PUBLIC UTILITY EASEMENTS -  
WILSONVILLE MEADOWS

Following the installation and acceptance of streets and public utilities for the Wilsonville Meadows Phase I subdivision, the plat was duly recorded with the corresponding utility easements and street dedications. As submitted by the Randall Co., the plat was recorded with six foot wide side and rear lot utility easements. As the individual lots are developed, rain drains, telephone, electricity, natural gas, etc., will be installed within those easements.

The minimum side and rear lot utility easement width is only five feet. The Randall Co. has deposited funds (\$300.00) and submitted a petition to initiate a vacation process which will reduce the utility easement width by one foot throughout the only phase of the Wilsonville Meadows plat which has been recorded. Subsequent phases will indicate side and rear lot utility easements which are five feet wide.

**Recommendation:**

Adopt Resolution No. CB-R-429-90 as presented.

ss:md

cc: Project file  
Inter-Office Communications - CD

EXHIBIT "A"

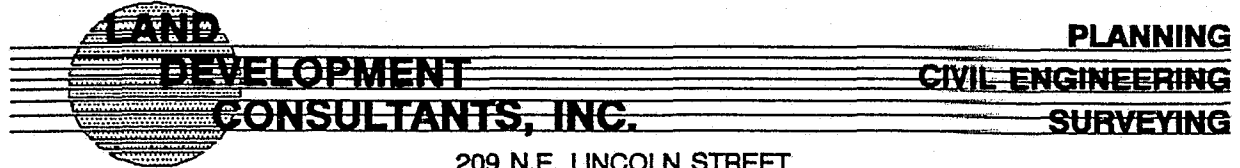

209 N.E. LINCOLN STREET  
HILLSBORO, OREGON 97124  
PHONE: (503) 648-4061 or FAX: (503) 681-7646

*Ryan O'Brien, Planner*  
*Chris Bedsaul, Planner*  
*John Darling, Planner, AICP*

*Bob Oquist, PLS*  
*Jerry Kraemer, PLS*  
*Duane Marx*

*J.H. (Dutch) Sigmund, PLS PE*  
*H.R. (Hugh) O'Reilly, PE*  
*Richard Girard, PLS CET*

Vacation of 1.00 foot lying interior to the lot of that certain 6.00 foot wide public utility easement along the side and rear lot lines of Lots 1 through 51 of the duly recorded plat of "Wilsonville Meadows," Book 93, Page 6, Clackamas County records, reducing and maintaining said 6.00 foot wide easement to 5.00 foot wide along all side and rear lot lines of said Lots 1 through 51, said plat.

wp101.parcel.565  
1/25/90

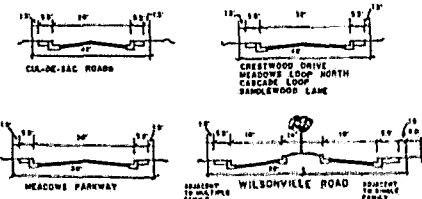
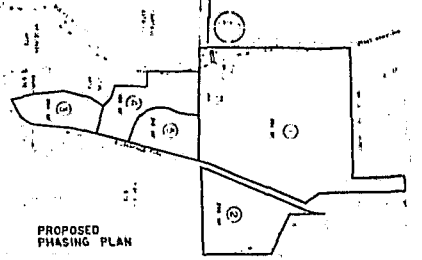
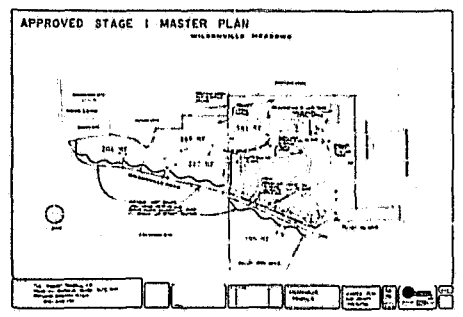
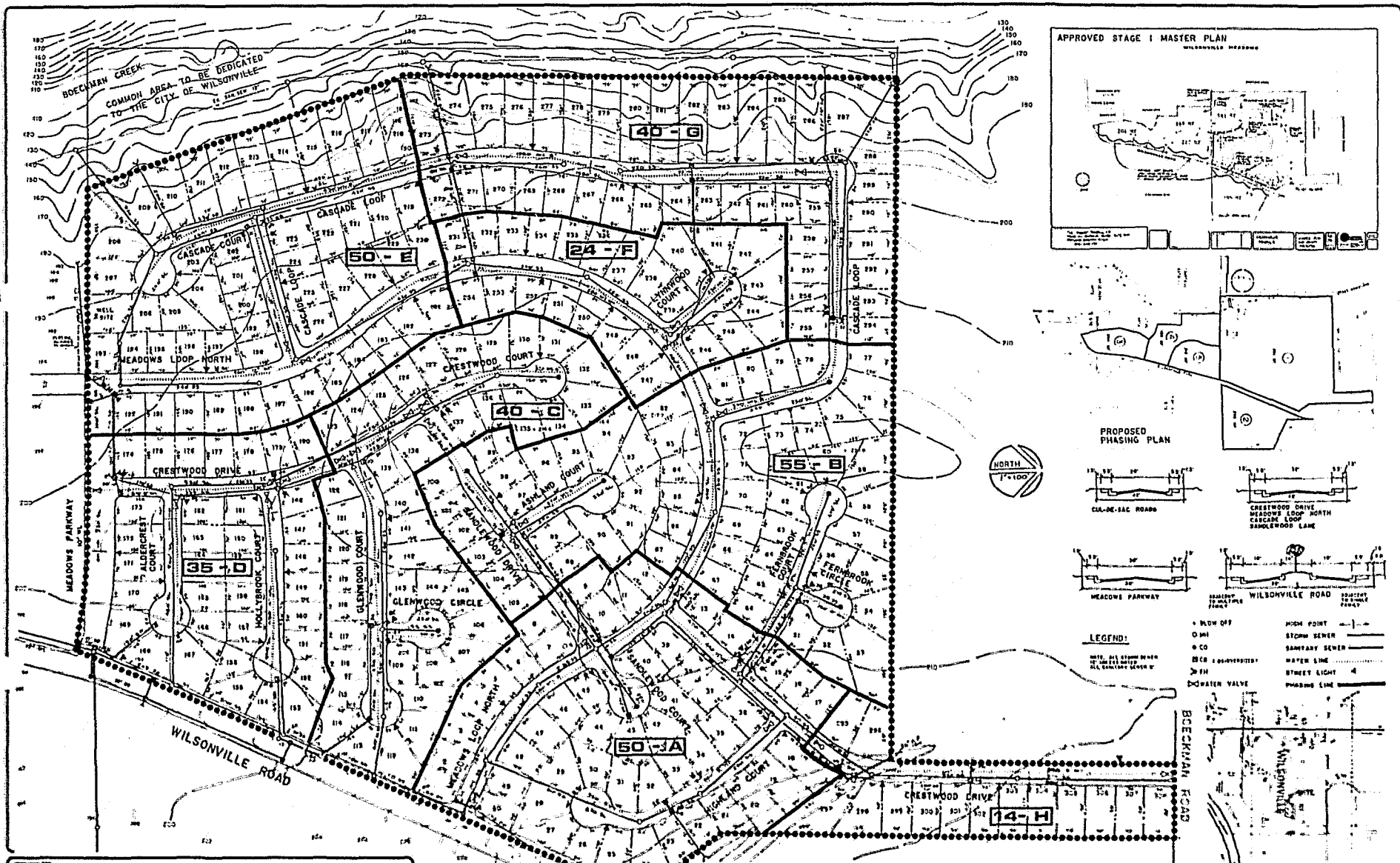

- LEGEND:**
- BLOW OFF
  - HIGH POINT
  - STORM SEWER
  - SANITARY SEWER
  - WATER LINE
  - STREET LIGHT
  - PHASING LINE
  - DRAIN VALVE

THE ROBERT RANDALL CO.  
 9500 SW BARBUR BLVD SUITE 300  
 PORTLAND, OREGON 97219  
 503 - 245-1131

NO.	DESCRIPTION	DATE
1	DESIGNED AND PHASING	8-15-88
2	120' HD. FLANGE CHANGES	8-15-88

**WILSONVILLE MEADOWS**  
 308 SINGLE FAMILY LOTS

**PHASE I PRELIMINARY PLAT**

**PREPARED BY:** **ENGINEERING CONSULTANTS, INC.**  
 27 JAMISON ST. PORTLAND, OREGON 97202  
 503-225-8800

**DATE:** 8-22-88

**SCALE:** 1" = 100'

**PROJECT NO.:** 88-01

**SHEET NO.:** 1

EXHIBIT "B"

WILSONVILLE MEADOWS

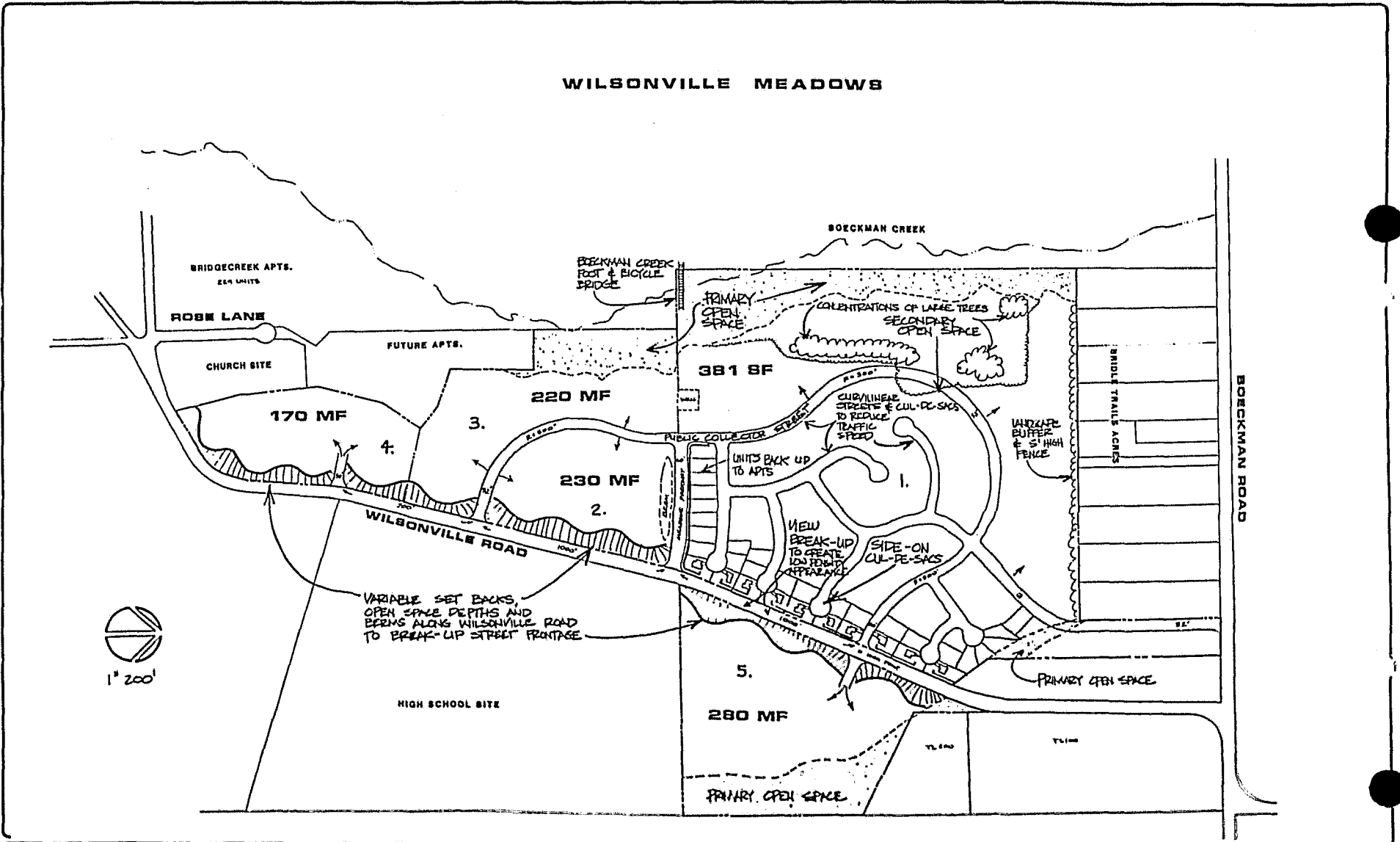

THE ROBERT RANDALL CO.  
 9500 SW BARBUR BLVD. SUITE 300  
 PORTLAND, OREGON 97219  
 503-245-1181



NO.	DESCRIPTION	DATE

PROJECT  
 WILSONVILLE  
 MEADOWS

DATE  
 MASTER PLAN  
 AND DENSITY  
 DISTRIBUTION

DATE  
 3-25-85

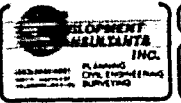

565

EXHIBIT 4F.